

1 Direct current motors with thermocouple and start relay

Type Description

56250A180L0H	Motor 12V 1800W
56250B200L0H	Motor 24V 2000W
56250A160L2K	D.C. Motor AMJ-5197 12V 1,6KW
56250B220L2K	D.C. Motor AMJ-5196 24V 2,2KW

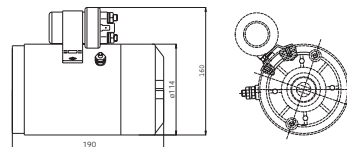

2 Fan D.C. Motor

Type Description

56250A150M4F	Fan Motor 12V 1500W D.113 B14-71
56250B200M4F	Fan Motor 24V 2000W D.113 B14-71
56250B300R2K	D.C. Motor AMK-5513 24V 3KW
4252BA250B2C	Fan Motor 12V 2500W D.125 B14/71
4252BB250B2C	Fan Motor 24V 2500W D.125 B14/71

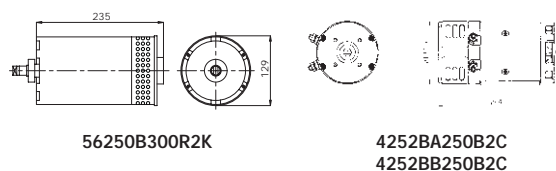

3 Direct current motors without start relay

Type Description

56150A050E2K	D.C. Motor AME-1726 12V 0,5 KW
56150B050E0K	D.C. Motor AME-1557 24V 0,5KW
56150A080F1K	D.C. Motor AME-1707 12V 0,8KW
56150B080F1K	D.C. Motor AME-1709 24V 0,8KW

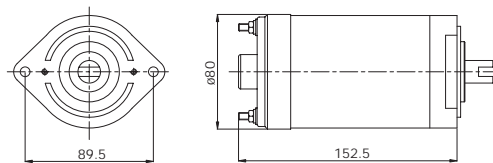

4 Direct current fan motors without thermocouple

Type Description

56250A150L5K	Fan D.C. Motor AMJ-5143 12V 1,5KW
56250B220L5K	Fan D.C. Motor AMJ-5233 24V 2KW

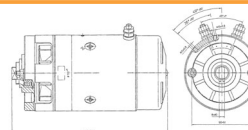

5 Thermocouple

Type Description

425Z0ST2422K	Motor thermocouple kit 12V-24V
--------------	--------------------------------

6 Starting relay

Type Description L (mm.) D (mm.)

56252120800K	12V 80A ARD1133	86	52
56252121500K	T12V 150A RINF. ARD1139	100	52
56252240800K	24V 80A ARD1134	86	52
56252241500K	24V 150A RINF. ARD1138	100	52

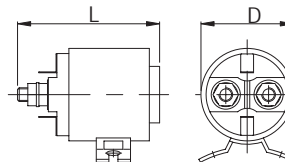

7 Protection cover for motor

Type Description

56253010000H	UPE-9
56253010000N	UPE-10

