

## 500W Motor/Pump Performance Guide

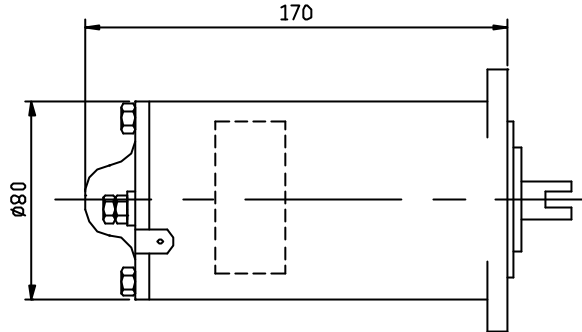

|                           |                       |
|---------------------------|-----------------------|
| Permanent Magnet DC Motor | Weight 2.6kg          |
| Reversible                | Terminal size 6mm     |
| Insulation Class F        | Protection Class IP54 |

Note: This data is a guide and for specific applications consult Hydraproducts.

